



**REFRESH® U 40 - REFRESH® U 80**  
**REFRESH® U 240 S – REFRESH® U 260 C**  
**Instructions for installation and use**

Thank you for choosing a Zerica® water dispenser.

Using the appliance is simple, however for best results, it is important to read the following instructions.

(010)

1. INTRODUCTION
2. UNPACKING
3. POSITIONING
4. CARTRIDGE INSTALLATION 3M
5. WATER CONNECTION
6. ELECTRICAL CONNECTION
7. USING THE PRODUCT FOR THE FIRST TIME
8. COLD CONTROL
9. COOLING CIRCUIT MAINTENANCE
10. WATER CIRCUIT MAINTENANCE
11. MAINTENANCE CHART
12. DEMOLITION AND DISMANTLING
13. WARRANTY
14. EC DECLARATION OF CONFORMITY

## 1.

### INTRODUCTION

This manual is the documentation and an integral part of the appliance and must accompany the product even if it is transferred or sold after first installation.

Its disclosure to all interested parties is a prerequisite for correct operation and protection from possible accidents and damage to the appliance and injury to third parties.

These instructions are intended to provide information regarding correct installation and operation.

The presence of such warnings does not imply that the manufacturer assumes any liability for any damage to property or injury to third parties caused by the use of the device, which has all the original certifications required in order to make it suitable for the use for which it has been designed, as well as safe in compliance with applicable standards.

The reproduction of the contents of this manual for distribution to third parties is strictly forbidden without the express prior consent of the manufacturer Zerica S.r.l.

This appliance is not intended for use by persons (including children) with reduced physical, sensory or mental capabilities, or lack of experience and knowledge, unless they have been given supervision or instructions concerning the use of the appliance by a person responsible for their safety. Children must be supervised to assure that they do not play with the machine.

The appliance must not be installed near water jets.

The appliance needs to be installed on a flat surface.

The appliance must not be cleaned with water jets.

The appliance is compliant with the N climate class and must be installed in locations with a temperature between +16°C and +32°C. Take all necessary precautions and do not install in locations with temperatures lower than +3°C because if the water inside the product freezes, it seriously damages the water circuit.

This appliance generates a sound pressure level below 70dB.

(020)

## 2.

### UNPACKING

Place the appliance in the upright position which can be easily identified by reading the direction mark "UP" on the box.

Open the package and check that there are no dents or obvious damages to the appliance caused by transportation.

**Any defects must be notified within 24 hours from delivery.**

In case of obvious defects or dents, do not install the appliance.

The packaging must be disposed of by the customer in accordance with current environmental protection regulations.

(030)



### 3. POSITIONING

Position the cooler in a clean, ventilated place and keep away from heat sources.

Leave a gap of at least 5 cm on each side and 25 cm by the ventilation slots.

If the ventilation slots are covered, the cooling system cannot operate properly and this inevitably leads to malfunctioning.

Do not place any objects on top of the product.



*Caution: non-compliance with the above conditions causes the compressor to overheat and break, leading to immediate invalidation of the warranty.*

For proper installation and use of the appliance, refer to the “First power on” paragraph.

(040)

#### 4. CARTRIDGE INSTALLATION 3M

The cartridge must be replaced in compliance with the data shown on the label, both for the months of use and the litres dispensed.



**Caution: before performing any intervention:**  
**disconnect the system from the water supply network or close the water inlet valve.**

#### WARNING

To reduce the risk associated with choking:

- To reduce the risk associated with choking, do not allow children under 3 years of age to have access to small parts during the installation of the product.

To reduce the risk associated with the ingestion of contaminants due to the use of microbiologically unsafe water or of unknown quality:

- Do not use with water that is microbiologically unsafe or of unknown quality without adequate disinfection of the system, before and after. Systems certified for protozoan cyst reduction, may be used with disinfected water containing filterable cysts. EPA Establishment Numb. 070595-MEX-001.

#### CAUTION:

To reduce the risk of property damage due to possible water leakage:

- Read and follow the instructions carefully before installation and usage of the filter cartridge.
- Protect from freezing by removing the filter cartridge when temperatures are expected to drop below 33° F (1° C).

#### REPLACEMENT OF THE FILTER CARTRIDGE



**IMPORTANT: The filter cartridge MUST be replaced every 6 months at the rated capacity or sooner, if a noticeable reduction in flow rate occurs.**

Note: The system is equipped with an internal by-pass valve.

- Turn cartridge slowly to the left until it stops (about a 1/4 turn). In this position, both inlet and outlet ports are closed and water pressure is relieved.
- Pull the used cartridge straight down and discard. Note: There may be a small amount of residual water drainage after pressure is relieved and during cartridge removal.
- Make sure the o-rings are accurately positioned in grooves. Moisten the o-rings with water. Push the new cartridge into the filter head. Turn the cartridge to the right until it stops (1/4 turn). Correct water flow will be restored when positioning of the cartridge is completed.
- Open the faucet or the downstream valve (if installed) and flush new filter cartridge for 2 minutes, expelling any trapped air and carbon fines. Water may run murky because of trapped air but will quickly appear clear.

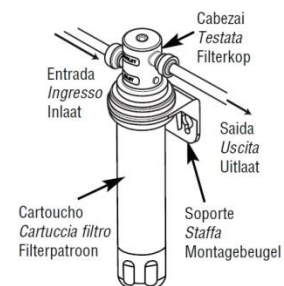
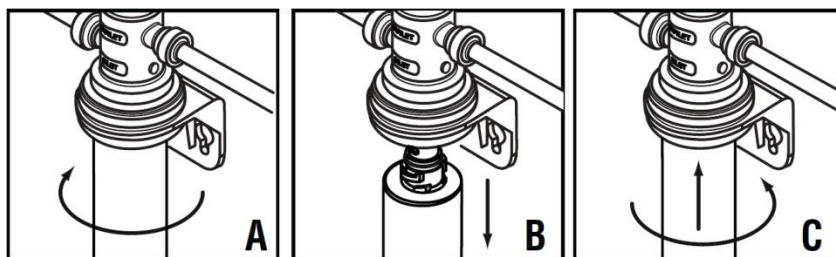

**Caution: : this appliance requires periodic maintenance in order to guarantee the drinkability requisites of the treated drinkable water and to maintain the improvements, as declared by the manufacturer.**



## 5. WATER CONNECTION



*The system must be connected to the potable water supply network.*



*If the system includes a filtration system, ensure that all the filter elements are properly installed before making any connection to the water supply.*

*Refer to the appropriate paragraph or instructions supplied with the filters for installation, maintenance and expiry.*

It is recommended to install a valve at the water input of the cooler, in order to isolate the system from the water supply whenever it is necessary. When the customer is not able to service, it is recommended to install a device that automatically stops water flow and isolates the product from the water circuit (our sales department is available for further technical specifications).

No tools are required to connect the system to the drinking water tube. Connection is carried out easily and within seconds, simply by inserting the tube directly into the rapid connection located on the back/side of the product.

This product can be supplied with ¼" rapid connections if the connections are white (or beige).

In this case, do not use 6 mm metric tubes as these are not suitable.

Before connecting the water tube be sure that there are no traces of impurities in the inlet rapid connection. A dust cap may be present, if so, it is necessary to remove it before water tube connection.

**The incoming water pressure must be between 0.250 MPa e 0.500 MPa.** The flow rate should not be less than 3 litres/minute.



*Check that the pressure remains constant even while water is being dispensed or at least that variations do not exceed 0.10 MPa. If this is not the case, reduce the length of the connection tube, or increase the internal cross-section.*

To ensure proper installation, it is recommended to use only certified food-grade tubes and fittings.



***CAUTION:** If incoming water pressure is unknown, a "water pressure reducer" must be installed and set to 0.250-0.300MPa. Again, check that the pressure is maintained within this range even while water is dispensed, or that variations do not exceed 0.10 MPa.*



***CAUTION:** If an excessive drop in water pressure is detected during delivery, switch off the product immediately and install it strictly in accordance with the above provisions.*

*Insufficient pressure causes damage to the pump in the water carbonation circuit, continuing intervention of the electronic protection device and invalidation of the warranty.*

(090)



## 6. ELECTRICAL CONNECTION

This product can be supplied with detachable power cord or with a no detachable power cord.



**If the detachable power cord is damaged, it must be replaced with a cable available from the manufacturer or its technical assistance service**

**If the not detachable power cord is damaged, it must be replaced by the manufacturer, its service agent or similarly qualified persons in order to avoid hazard**

Make sure that the power supply to the appliance is the same as the voltage indicated on the label on the side of the appliance. The appliance must be grounded in compliance with applicable standards and laws. In case of malfunctioning, grounding reduces the risk of electrical shocks.

Connect the appliance cable to a double-pole switch with a minimum of at least 3 mm distance between the contacts, or using a plug which must still be accessible after installation.

(080)

### PRODUCTS VIEW

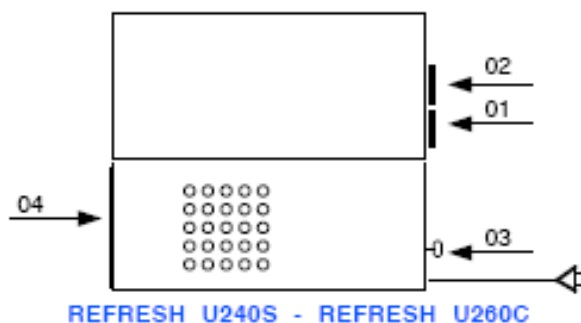
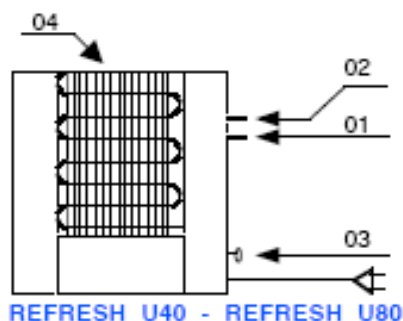

01	ENTRATA ACQUA	INLET WATER	
02	USCITA ACQUA REFRIGERATA	OUTLET COLD WATER	
03	TERMOSTATO	THERMOSTAT	
04	CONDENSATORE	CONDENSING UNIT	
05	SPIA ALIMENTAZIONE ELETTRICA	MAIN POWER LIGHT	
06	SPIA DI FUNZIONAMENTO DEL COMPRESSORE FRIGORIFERO	COOLING/COMPRESSOR LIGHT	



## 7.

### **USING THE PRODUCT FOR THE FIRST TIME**

When you first use the product, in order to remove any air inside the system, it is recommended to:

- a. Open the water valve and wait a few minutes to make sure there are no water leakage.

If the system includes electrical controls, connect the product to the power supply to enable the delivery keys.

- b. Press the cold water button to let the air out. Release the button only when the water starts coming out.
- c. Drain at least 30 litres of cold water and , if the system includes it, a few litres of the ambient water.
- d. When you first install the product, you will have to wait a few hours before dispensing cold water.

For products with the HPDC® – High Performance Direct Chill – system, waiting times are a few minutes.

(102)



## 8. COLD CONTROL

It is possible to enable and disable cold water dispensing as well as temperature control by acting on the thermostat. During periods with low water collection it is better to set the thermostat at minimum.

During periods with high water collection it is better to set the thermostat at maximum. In this way the cooling circuit is able to provide an ice reserve that would be necessary during the times of high operation of the machine.

To modify the temperature just turn the control handle (or the regulation screw) following the label placed near the thermostat. Higher values means colder water.

**NOTE: It will take a couple of hours before the temperature is changed to the new value set.**

(110)

## 9. COOLING CIRCUIT MAINTENANCE

The cooling system requires no maintenance. Leave a gap of at least 5 cm on each side. This gap must be at least 25 cm by the ventilation slots. Periodically check that the ventilation slots are clear and not obstructed, then remove any impurity deposited on the ventilation slots using a brush or a vacuum cleaner.



**CAUTION: Failure to clean the condenser and poor ventilation of the cooling circuit can cause the compressor to overheat and break. These causes invalidate the WARRANTY and any repair cost will be charged.**

(130)

## 10. WATER CIRCUIT MAINTENANCE

Cleaning should take place at the following times:

- The first time the product is installed (dispense some water for at least a couple of minutes)
- When parts or pieces in contact with water are replaced
- When pollution is suspected or has occurred. This may manifest itself as a bacterial infection with a bad smell/taste of the water or if the water is cloudy.
- Any new installation
- If system has not been used for 5 days

(140)







## 12.

### DEMOLITION AND DISMANTLING

The user has the obligation to dispose of the device at the end of its life cycle in compliance with the current regulations and in particular the requirements of the WEEE directives, regarding the disposal of equipment and machines.



This symbol on the product or in the instructions means that your electrical and electronic equipment should be disposed at the end of life separately from household waste. There are separate collection systems for recycling in the EU. For more information, please contact the local authority or your retailer where you purchased the product.

(210)

## 13.

### WARRANTY

**ZERICA® S.r.l.** guarantees ZERICA® products purchased from ZERICA® S.r.l. or from an authorised dealer against material or manufacturing defects, on the conditions that the ZERICA® products are new at the time of purchase. The product is covered by a **legally-compliant warranty** as follows:

**for consumers**, i.e. persons who purchase for purposes unrelated to their profession or business, the seller shall apply Italian Legislative Decree n° 24 of 2 February 2002 art. 1519-bis et seq. of the Italian Civil Code (two years from delivery in compliance with legal requirements)

**for other purchasers**, who usually purchase for their profession or business, the legal warranty referred to in articles 1490 et seq. of the Italian Civil Code shall apply (one year from delivery in compliance with legal requirements).

During the period of validity of the warranty, ZERICA® undertakes to repair or replace free of charge those parts which, within the warranty period, prove to be inefficient in its opinion. Total replacement of the appliance is not included and claims for compensation for damages, caused in whatever circumstances, shall not be acknowledged. Repairs shall be performed at our authorised Service Centre.

**For repairs at home**, the customer is required to pay a “set charge” as partial reimbursements for travelling costs for personnel.

**For repairs in the laboratory**, the products must be shipped to an Authorised Technical Service Centre, enclosing your name, address, telephone number and a description of the problem and in any event by filling out the RMA form. Transport costs shall be borne by the purchaser. You can get more information by contacting ZERICA® S.r.l. at the address below. There may be delays in the repair or replacement of components that are found to be faulty at source, in the event that they are not in stock.

The warranty excludes those products that (I) in the opinion of ZERICA® have been damaged accidentally or during transportation if not notified to ZERICA Srl® directly within 8 days from the date of purchase, or due to incorrect or improper use or inappropriate or incorrect application, or following intervention or verifications or modifications carried out by anyone other than a ZERICA® Authorised Service Centre (tampering), or (II) in relation to defects or non-functioning as a result of normal wear and tear, or (III) where there has been a breach of your contractual obligations. If, after investigation by ZERICA® S.r.l., your request for repair/replacement under the warranty is found not to fall under the scope of the situations or the duration of this warranty, the expenses incurred for said investigation and repair/replacement shall be borne solely by the purchaser. The following are excluded from the warranty: knobs, moving or removable components, glass parts, light bulbs or indicator lights, data plates, all accessories and saturated filters. ZERICA® S.r.l. shall not be liable for any damage caused directly or indirectly to persons or property following failure to observe all the instructions provided in the booklet accompanying the appliance. The warranty limitations and disclaimers above are only limited by mandatory rules and shall therefore be effective to the maximum extent permitted by such rules.

The Court of Palermo is the only competent court for any dispute.

**Validity of the warranty.** The product warranty is valid **only** if the coupon is completed in its entirety and sent by fax or e-mail **within 8 days of the date of purchase** to ZERICA® S.r.l.

**Complete the “Code n°” with the serial number present on the data plate affixed to the product.**

The warranty certificate remains in the possession of the purchaser and must be presented to technical personnel or accompany the appliance if sent for repair.

(220)

# GARANZIA



**1**

dati del proprietario

nome e cognome

via

c.a.p.

città

prov.

**2**

dati del proprietario

nome e cognome

via

c.a.p.

città

prov.

modello

timbro del rivenditore

matricola

data di acquisto

modello

timbro del rivenditore

matricola

data di acquisto



## 14.

### EC DECLARATION OF CONFORMITY

Manufacturer: ZERICA s.r.l.

Address: Zona Industriale – 90018 Termini Imerese (PA)

Declares under its responsibility that this product:

*Complies with the requirements of EEC Directive (2006/95/EC) - low tension directive*

*Complies with the requirements of EEC Directive (2004/108/EC - EMC) – electromagnetic compatibility;*

#### **Electrical safety:**

- CEI EN 60335-1 :2013-01
  - Safety of electrical appliances for household and similar use. Part 1: General requirements..
- CEI EN 60335-2-89/2011
  - Electrical appliances for household and similar purposes - Safety. Part 2: Particular requirements for appliances for commercial refrigeration condensing unit of refrigerant, compressor or an incorporated or remote

#### **Electromagnetic compatibility:**

- CEI EN 55014-1/2008+A1-2010+A2-2012  
Electromagnetic compatibility. Requirements for household appliances, electric tools and similar apparatus. Part 1: Emission.
- CEI EN 55014-2/1998+A1-2002+IS1-2007+A2-2009
  - Electromagnetic compatibility. Requirements for household appliances, electric tools and similar apparatus. Part 2: Immunity.
- CEI EN 61000-3-2/2007+A1+A2-2011 Part 3-2:
  - Electromagnetic compatibility. Part 3: Limits - Section 2: Limits for harmonic current emissions (equipment input current less than 16A per phase).
- CEI EN 61000-3-3/2014
  - Electromagnetic compatibility. Part 3: Limits - Section 3: Limitation of voltage fluctuations and flicker in low-voltage supply systems for equipment with rated current less than 16A and not subject to conditional connection.

Declares under its responsibility that this product:

- Complies with Directive 2011/65/CE (RoHS 2)- “Restricting the use of certain hazardous substances in electrical and electronic equipment” - RoHS.
- The carbonators used by ZERICA S.r.l. have been designed and produced according to sound engineering practice, tested according to the reference procedures and are suitable for use in systems for producing sparkling water, using only drinking water and CO2 at a maximum operating pressure of 7 bar.
- The carbonators are inserted in systems subject to the Machinery Directive (89/392/EC) or the Low Voltage Directive (73/23/EC) and therefore do not fall within the scope of the Pressure Equipment Directive - PED (97/23/EC) according to the exclusions in art. 1 point 3.6. of said Directive.
- In addition, the models of carbonators used by Zerica have a product PSxV below the limit established by the PED, at 50, and do not therefore have to be CE-marked as they come under the equipment referred to in art. 3§3 in said directive.

(230)

Zerica has also requested verification of conformity assessment pursuant to the Italian Decree of 6 April 2004 no. 174 in compliance to REGULATION (EEC) N. 1935/2004 - "materials that come into contact with the water destined for human consumption" for the following components:

- Plastic fittings in contact with water are NSF, FDA and SK certified and meet the Italian provisions of the ministerial decree no. 174 of April 06, 2004
- Plastic tubes in contact with water are NSF, FDA and SK certified and meet the Italian provisions of the ministerial decree no. 174 of April 06, 2004
- Turboclean system - consisting of stainless steel components - "Test Report No. 1206/09 issued on 11 May 2009 by G.R. Biochemilab in Modena.
- Stainless steel coils and stainless steel pipes - "Test Report No. 1200/09 issued on 11 May 2009 by G.R. Biochemilab in Modena.
- Brass fittings - "Test Report No. 1202/09 issued on 11 May 2009 by G.R. Biochemilab in Modena.
- Brass fittings - "Test Report No. 1203/09 issued on 11 May 2009 by G.R. Biochemilab in Modena.
- HPDC system - consisting of food-grade copper components - "Test Report No. 1201/09 issued on 11 May 2009 by G.R. Biochemilab in Modena.
- Plastic fittings - "Test Report No. 51/10 AMB issued on 10 December 2010 by Bioanalisi in Erice.
- Nickel-plated brass fittings - "Test Report No. 51/10 AMB issued on 10 December 2010 by Bioanalisi in Erice.
- Brass fittings - "Test Report No. 51/10 AMB issued on 10 December 2010 by Bioanalisi in Erice.
- Plastic taps - "Test Report No. 51/10 AMB issued on 10 December 2010 by Bioanalisi in Erice.
- Plastic head - "Test Report No. 51/10 AMB issued on 10 December 2010 by Bioanalisi in Erice.
- Teflon chamber - "Test Report No. 51/10 AMB issued on 10 December 2010 by Bioanalisi in Erice.
- Blue plastic diffuser - "Test Report No. 51/10 AMB issued on 10 December 2010 by Bioanalisi in Erice.
- AISI 304 stainless steel chamber - "Test Report No. 51/10 AMB issued on 10 December 2010 by Bioanalisi in Erice.
- Glass bottle - "Test Report No. 51/10 AMB issued on 10 December 2010 by Bioanalisi in Erice.

Wherefore states the conformity of the appliance to the Decree of April 06, 2004 no.174

- **Turboclean system - consisting only of components codes SL BARIL OXX is Tested and Certified by NSF International**



(231)



Thirsty for innovation.

[www.zerica.com](http://www.zerica.com) • [info@zerica.com](mailto:info@zerica.com)

**ZERICA srl**

Zona Industriale

90018 Termini Imerese (Pa) - Italy

Tel. +39.091.8140341 – 091.8140377 – 091.8167962 – 091.9293333 Fax +39.091.8140364

<http://www.zerica.com> e-mail:[info@zerica.com](mailto:info@zerica.com)

Total or partial reproduction is forbidden. The manufacturer disclaims any responsibility for any typographical errors included in this manual. It reserves the right to make amendments to own products considered necessary or useful without jeopardising their functional features, without prior notice.

(300)